

NMAAHC EIS & Section 106 Process



Consulting Parties
Meeting #4

June 27, 2007

Presentation of Final Alternatives

ALT. 1

“Contextual Building Alignment ”

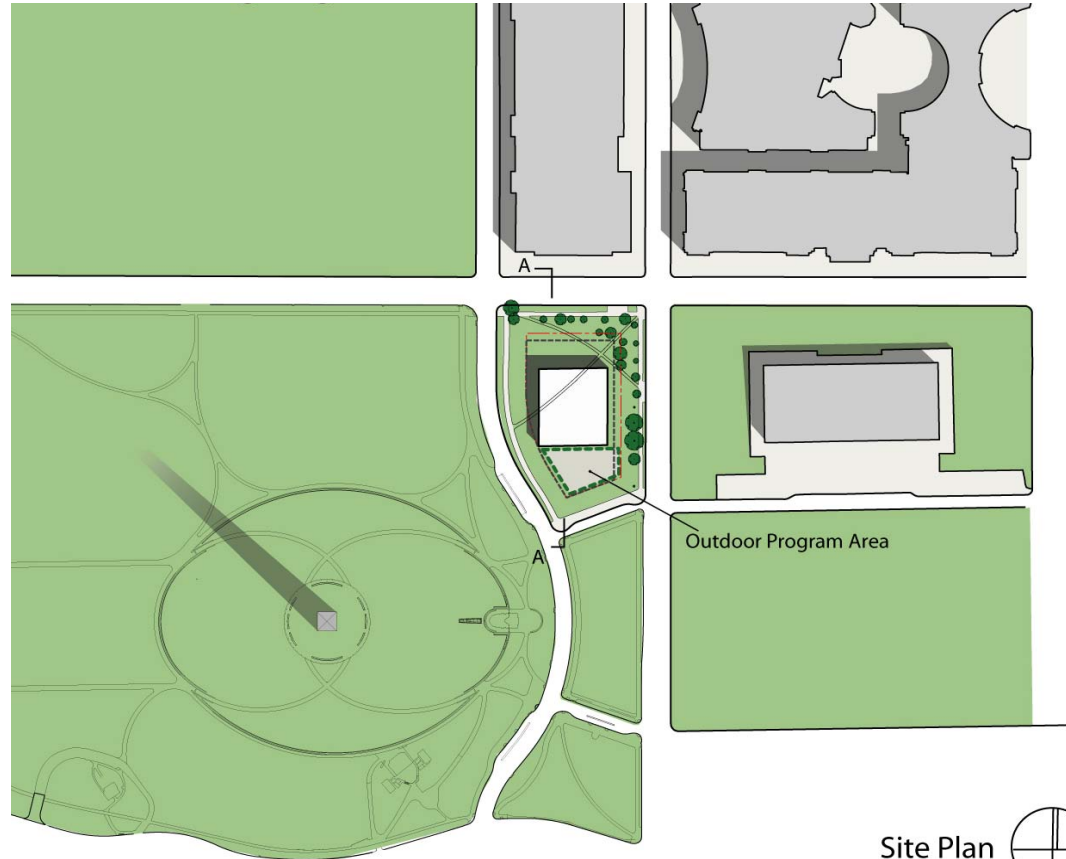

Site Plan 

* Monument Grounds data provided by NPS and does not represent as-built conditions.

Program:

Above Grade	43,800 x 5	= 219,000 SF	75'
Below Grade	98,000 x 2	= 196,000 SF	
Total		415,000 SF	

Section A-A

ALT. 1

“Contextual Building Alignment ”

Program:

Above Grade 43,800 x 5 = 219,000 SF 75'
Below Grade 98,000 x 2 = 196,000 SF
Total 415,000 SF

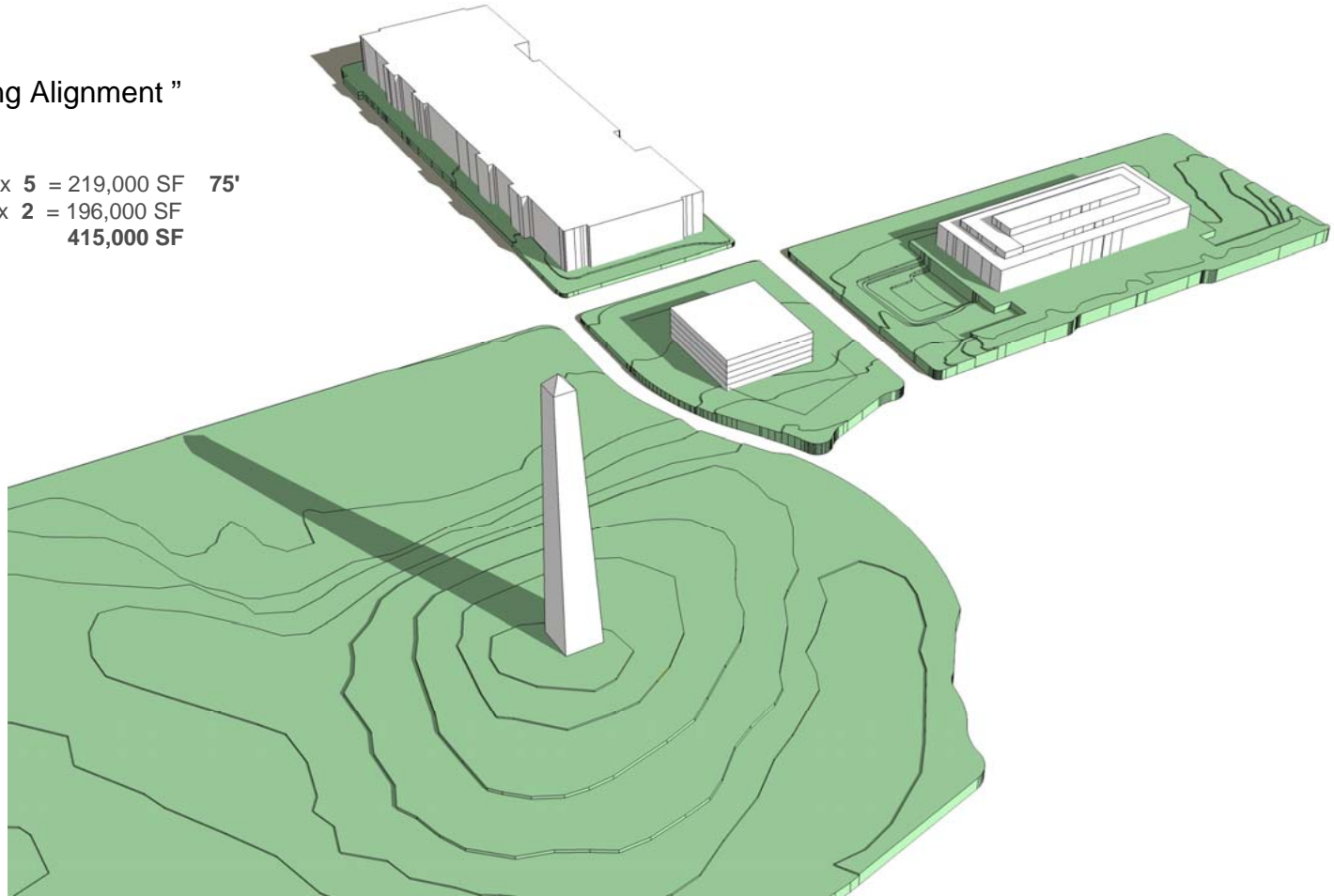

ALT. 2

“Washington Monument Orientation”

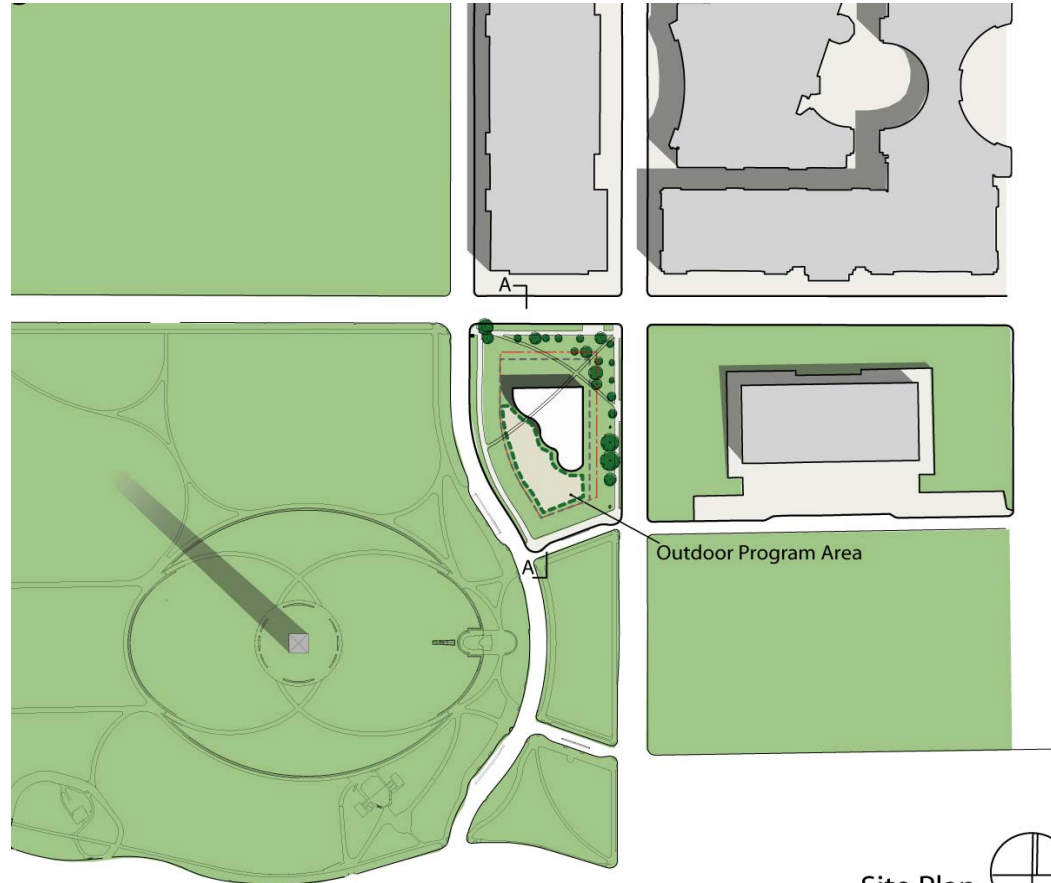

* Monument Grounds data provided by NPS and does not represent as-built conditions.

Program:			
Above Grade	30,000 x 6	= 180,000	90'
Below Grade	98,000 x 2	= 196,000	
Total		376,000	

Section A-A

ALT. 2

“Washington Monument Orientation”

Program:

Above Grade	30,000 x 6 = 180,000	90'
Below Grade	98,000 x 2 = 196,000	
Total	376,000	

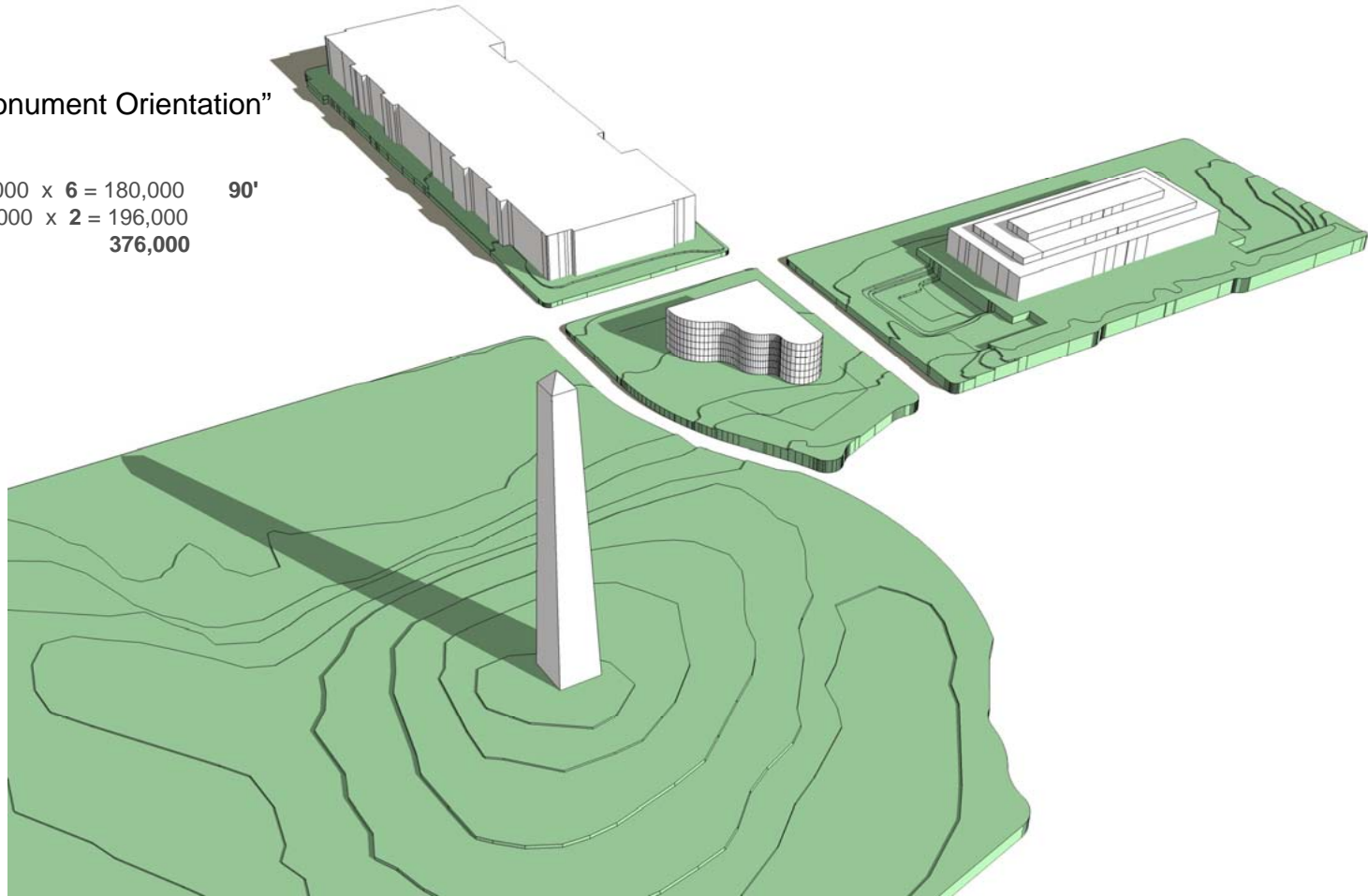

ALT. 3

“Free Form”

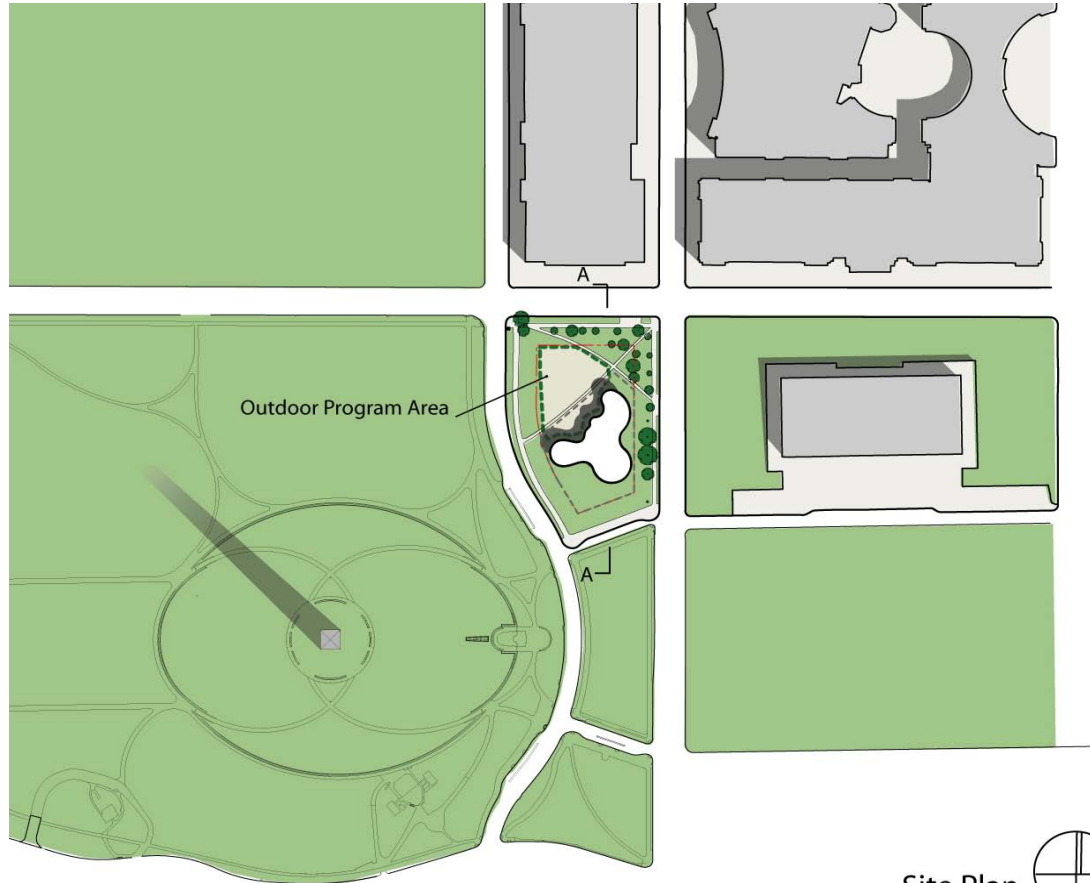

Site Plan 

* Monument Grounds data provided by NPS and does not represent as-built conditions.

Program:

Above Grade	30,000 x 7 = 210,000	105'
Below Grade	67,000 x 3 = 201,000	
Total	411,000	

Section A-A

ALT. 3

“Free Form”

Program:

Above Grade 30,000 x 7 = 210,000 **105'**

Below Grade 67,000 x 3 = 201,000

Total **411,000**

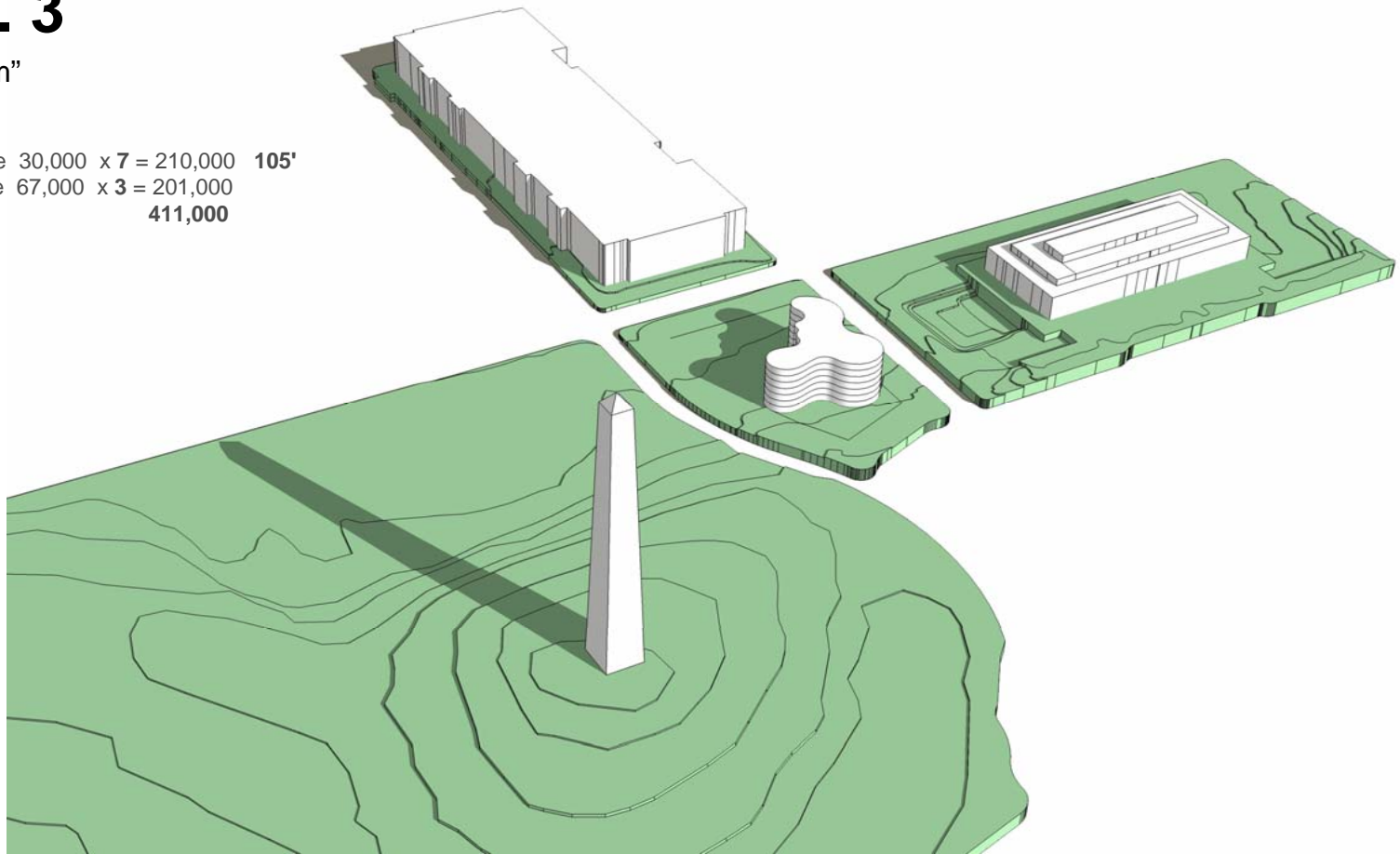

ALT. 4

"Terraced Roof"

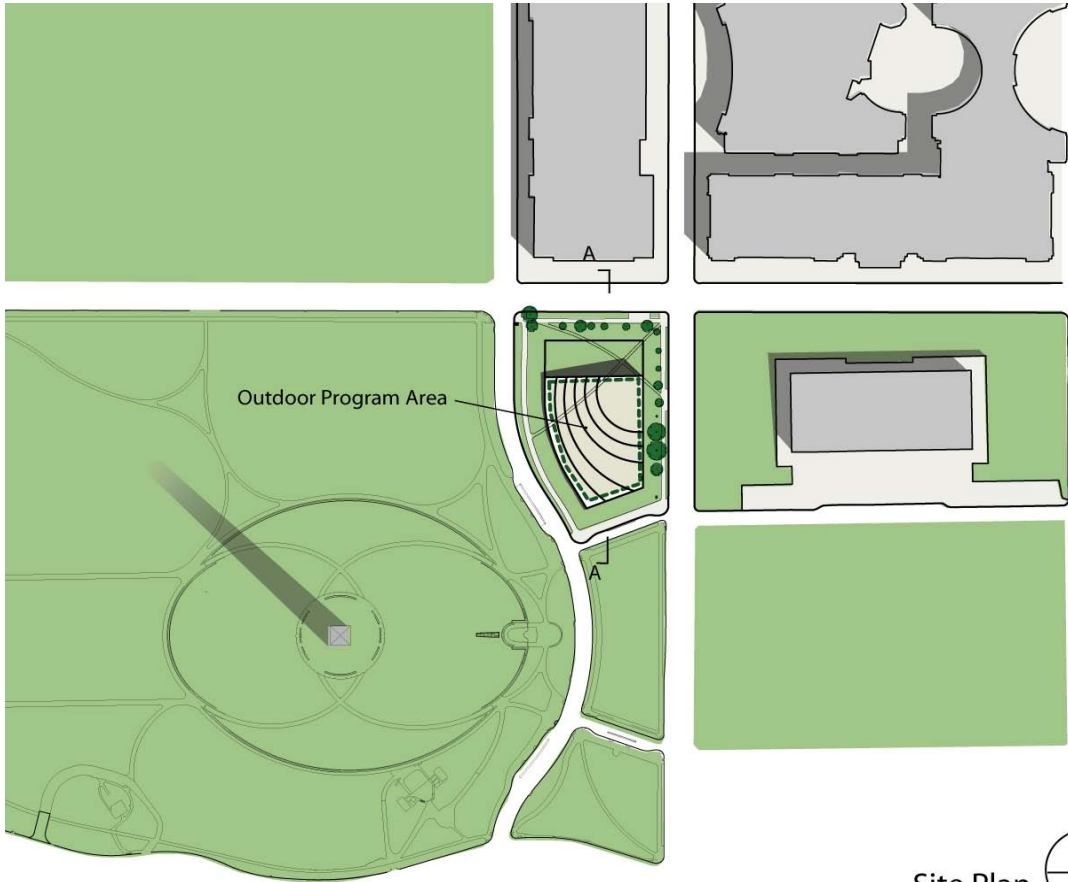

Site Plan 

* Monument Grounds data provided by NPS and does not represent as-built conditions.

Program:

Above Grade	various floor plate @ 6	= 274,000	90'
Below Grade	111,500 x 1	= 111,500	
Total		385,500	

Section A-A

ALT. 4

“Terraced Roof”

Program:

Above Grade	various floor plate @ 6 = 274,000	90'
Below Grade	111,500 x 1 = 111,500	
Total	385,500	

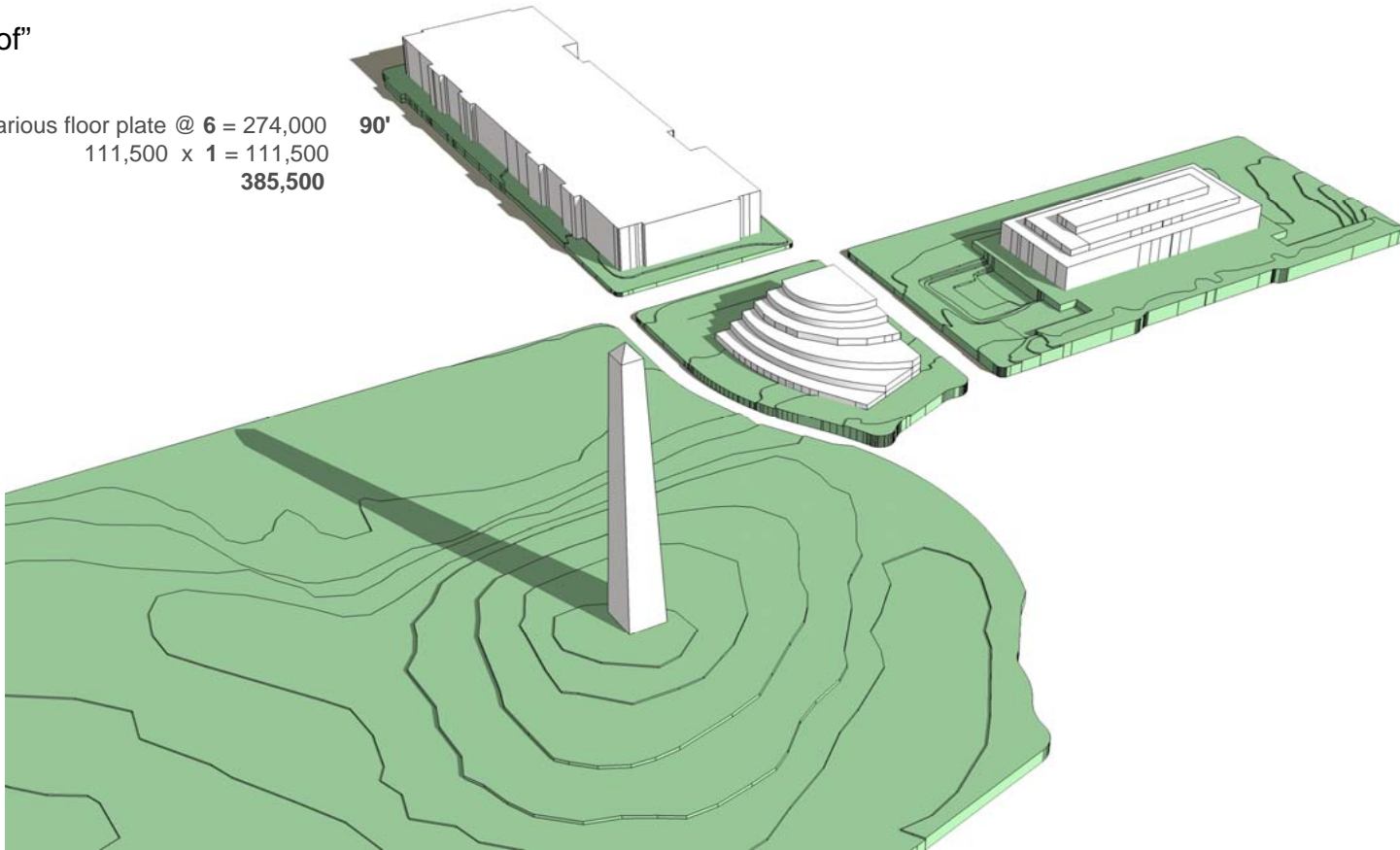

ALT. 5

“Enframing”

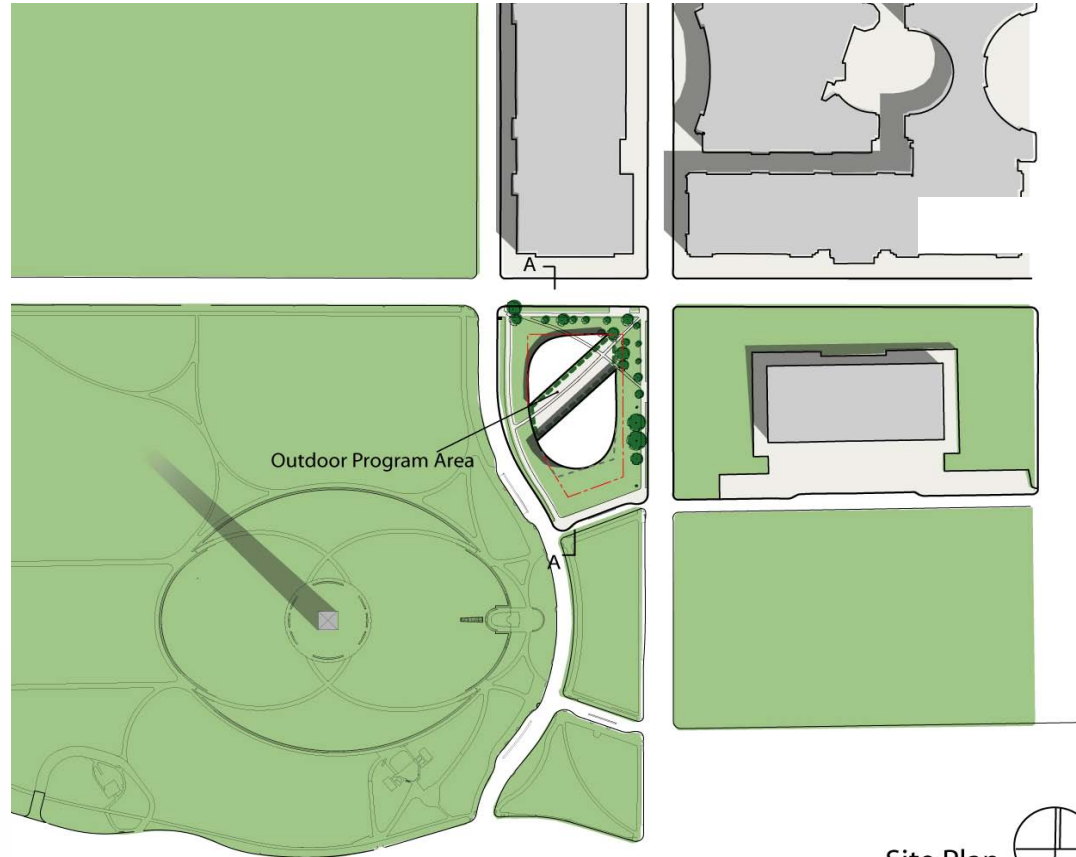

Site Plan 

* Monument Grounds data provided by NPS and does not represent as-built conditions.

Program:

Above Grade	36,000 x 6 = 216,000	90'
	20,000 x 2 = 20,000	30'
Below Grade	78,000 x 2 = 174,000	
Total	430,000	

Section A-A

ALT. 5

“Enframing”

Program:

Above Grade	36,000 x 6 = 216,000	90'
	20,000 x 2 = 20,000	30'
Below Grade	78,000 x 2 = 174,000	
Total	430,000	

